

KINNERTON STREET ACCESS TO BE MADE TWO-WAY TEMPORARILY

10m OF CLOSED CONE AREA TO BE SET UP TO PREVENT PARKING FOR THE DURATION OF THE WORKS

PROPOSED TEMPORARY TRAFFIC SIGNALS FOR RIGHT TURNING TRAFFIC

PARKING TO BE SUSPENDED FOR THE DURATION OF THE WORKS

PROPOSED TEMPORARY TRAFFIC SIGNALS FOR LEFT TURNING TRAFFIC

10m OF CLOSED CONE AREA TO BE SET UP TO PREVENT PARKING FOR THE DURATION OF THE WORKS

PROPOSED TEMPORARY TRAFFIC SIGNALS FOR LEFT TURNING TRAFFIC

PROPOSED TEMPORARY TRAFFIC SIGNALS FOR RIGHT TURNING TRAFFIC

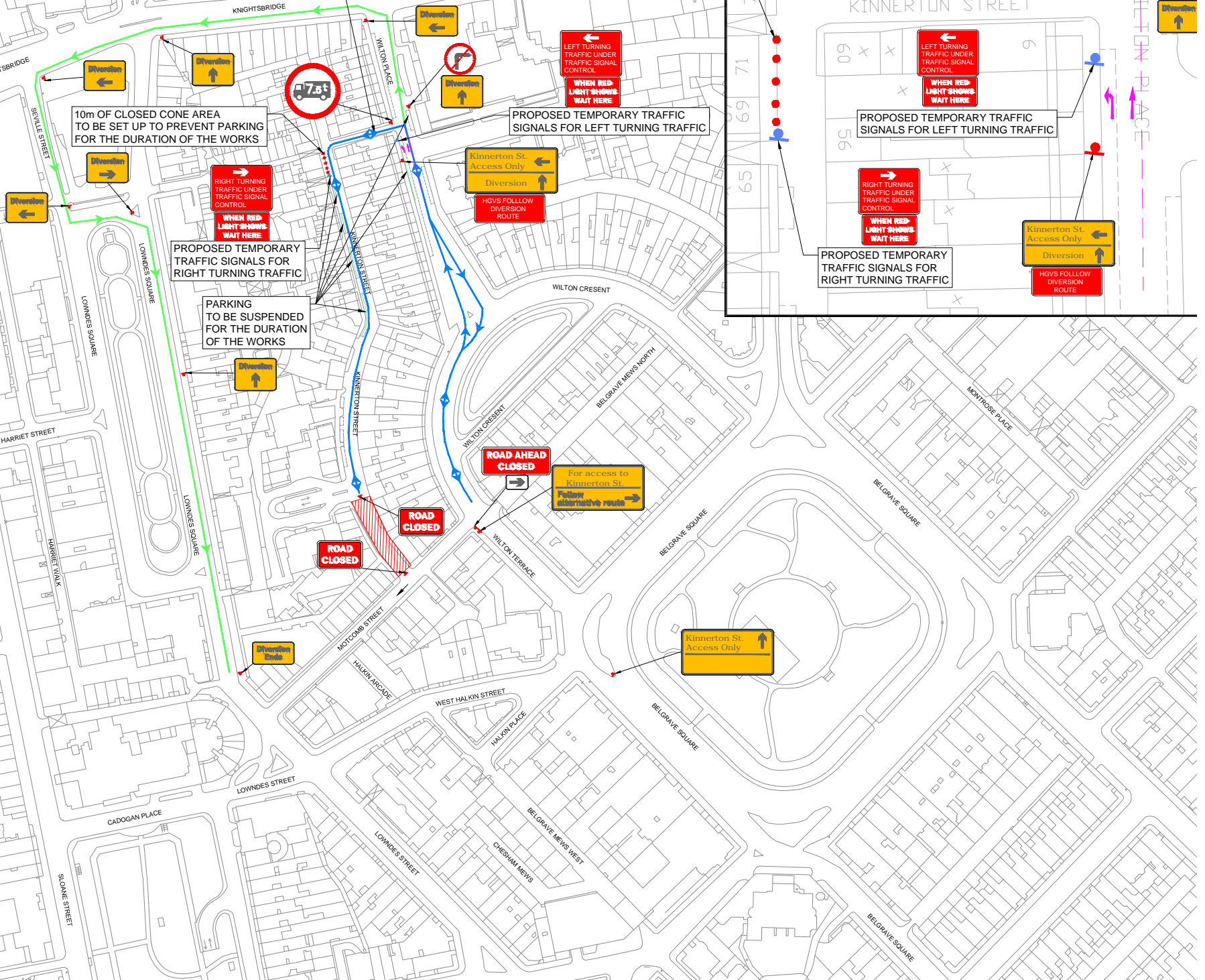

ROAD AHEAD CLOSED

ROAD CLOSED

ROAD CLOSED

For access to Kinnerton St. Follow alternative route

Kinnerton St. Access Only

Diversion

Diversion

Kinnerton St. Access Only

HGVs FOLLOW DIVERSION ROUTE

Diversion

Diversion

Diversion

Diversion

RIGHT TURNING TRAFFIC UNDER TRAFFIC SIGNAL CONTROL

WHEN RED LIGHT SHOWS WAIT HERE

LEFT TURNING TRAFFIC UNDER TRAFFIC SIGNAL CONTROL

WHEN RED LIGHT SHOWS WAIT HERE

Diversion

Diversion

Kinnerton St. Access Only

HGVs FOLLOW DIVERSION ROUTE

Diversion